

PORTABLE TYPEWRITERS

Instructions

DORA 201

KR2845SC.

The CE mark affixed to the product certifies that the product satisfies the basic quality requirements.



Your attention is drawn to the following actions that could compromise the characteristics of the product:

- incorrect electrical supply;
- incorrect installation; incorrect or improper use, or, in any case, not in accordance with the warnings given in the User Manual supplied with the product;
- replacement of original components or accessories with others of a type not approved by the manufacturer, or carried out by unauthorized personnel.

BEFORE YOU BEGIN

Congratulations on your choice! This guide will help you get the best out of your typewriter.

Before you start using the typewriter, check that the transport blocks have been removed and make sure you know where the electric cable is. You will find all the necessary information in the unpacking instructions printed on the inside cover of the packing. The pull-out handle under the keyboard can be used to transport the typewriter.

Safety: Your typewriter conforms to all the current safety norms and requires the same precautions taken with everyday appliances. See "Technical Data, Norms and Safety Regulations".

Accessories: The three accessories necessary for using all the available features are already installed in your typewriter: the daisy wheel, ribbon cartridge and correction tape (see the relevant modules).

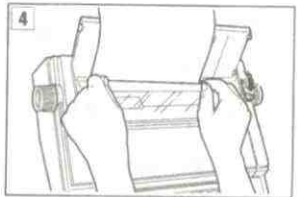
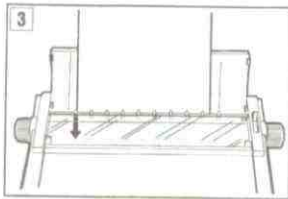
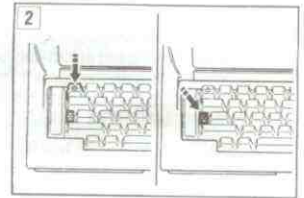
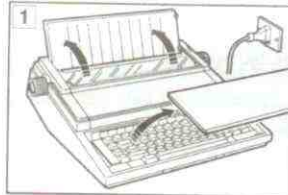

1	1 1/2	2
xxxxxx	xxxxx	xxxxx
xxxxxx	xxxxx	xxxxx
xxxxxx	xxxxx	xxxxx
xxxxxx	xxxxx	xxxxx

